

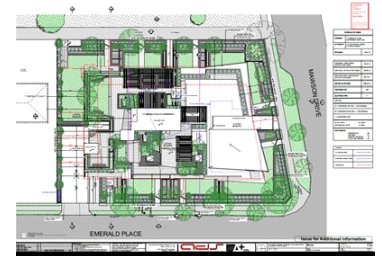

RESIDENTIAL DEVELOPMENT

1-5 EMERALD PLACE | CARTWRIGHT, NSW



1-5 Emerald Place, Cartwright

DA Approved for 27 Units

An exceptional opportunity for developers and investors to acquire a DA approved site for 27 Units, which offers the following compelling highlights. Features:

- Total site area - 1789 sqm
- 3 adjoining properties in one line
- 4 storey construction
- One basement carpark
- 27 Unites comprising of
 - 3x 1 Bedrooms
 - 23x 2 Bedrooms
 - 1x 3 Bedrooms
- Massive growth opportunities
- Perfectly located in one of the fastest growing locations of South Western Sydney with easy access to M5 & M7 motorways

2 2

Contact Agent

ID# 11417100251



Domenic Fortuna
(02) 9734 6001
0423 030 159

The above information has been furnished to us by the vendor of each property. We have not verified whether or not that information is accurate and have no belief one way or another in its accuracy. We do not accept any responsibility to any person for its accuracy and do no more than pass it on. all interested parties should make and rely upon their own enquires in order to determine whether or not this information is in fact accurate.