

279 Kings Road, Paralowie

Stylish, low-maintenance lifestyle

Welcome to 279 Kings Road, Paralowie.

Built in 1991 on a block of approximately 420sqm, this home presents the perfect opportunity for a first home buyer or savvy investor looking to purchase a neat four-bedroom home. Having been updated throughout, the property presents a low-maintenance and stylish lifestyle.

The home features a separate formal lounge area at the front of the home with a roller shutter on the window. The main bedroom is also at the front of the home and has a mirrored built-in robe, ceiling fan and roller shutter on the window. The other three bedrooms are towards the back of the property and all feature built-in robes. Both the kitchen and bathroom have been stunningly renovated. The kitchen features gas cooking appliances while the bathroom has been tiled to the ceiling. Additionally, evaporative air conditioning keeps the home at an ideal temperature during the warmer months.

Out the back, there is a flat roof entertaining area connected to a single carport providing secure parking behind an automatic roller door. A large iron shed with lights and power, glass sliding door and a concrete floor presents a perfect opportunity for those looking for their very own games room, workshop or man cave. Down the side is a shade cloth pergola with plenty of room for an avid gardener. All this does not sacrifice on the back lawn space either with a beautiful rear garden setup.

Located on a service road off the main road, the property is located a short walk from public transport routes, a short drive to shopping centres including Paralowie Village and Paralowie Plaza Shopping Centre. A number of schools are also located nearby with Bethany Christian School, Settlers farm R-7, Riverdale Primary School and The Pines Primary School all being a short drive away. In addition, both Aldi in Parafield Gardens and the Krispy Kreme at Bolivar are located close-by.

4 1 1

420 sqm

\$289,000 - \$299,000

ID# 11806100269



Michael Janda
0417 856 970



Nathan Janda
0411 150 489

The above information has been furnished to us by the vendor of each property. We have not verified whether or not that information is accurate and have no belief one way or another in its accuracy. We do not accept any responsibility to any person for its accuracy and do no more than pass it on. all interested parties should make and rely upon their own enquires in order to determine whether or not this information is in fact accurate.

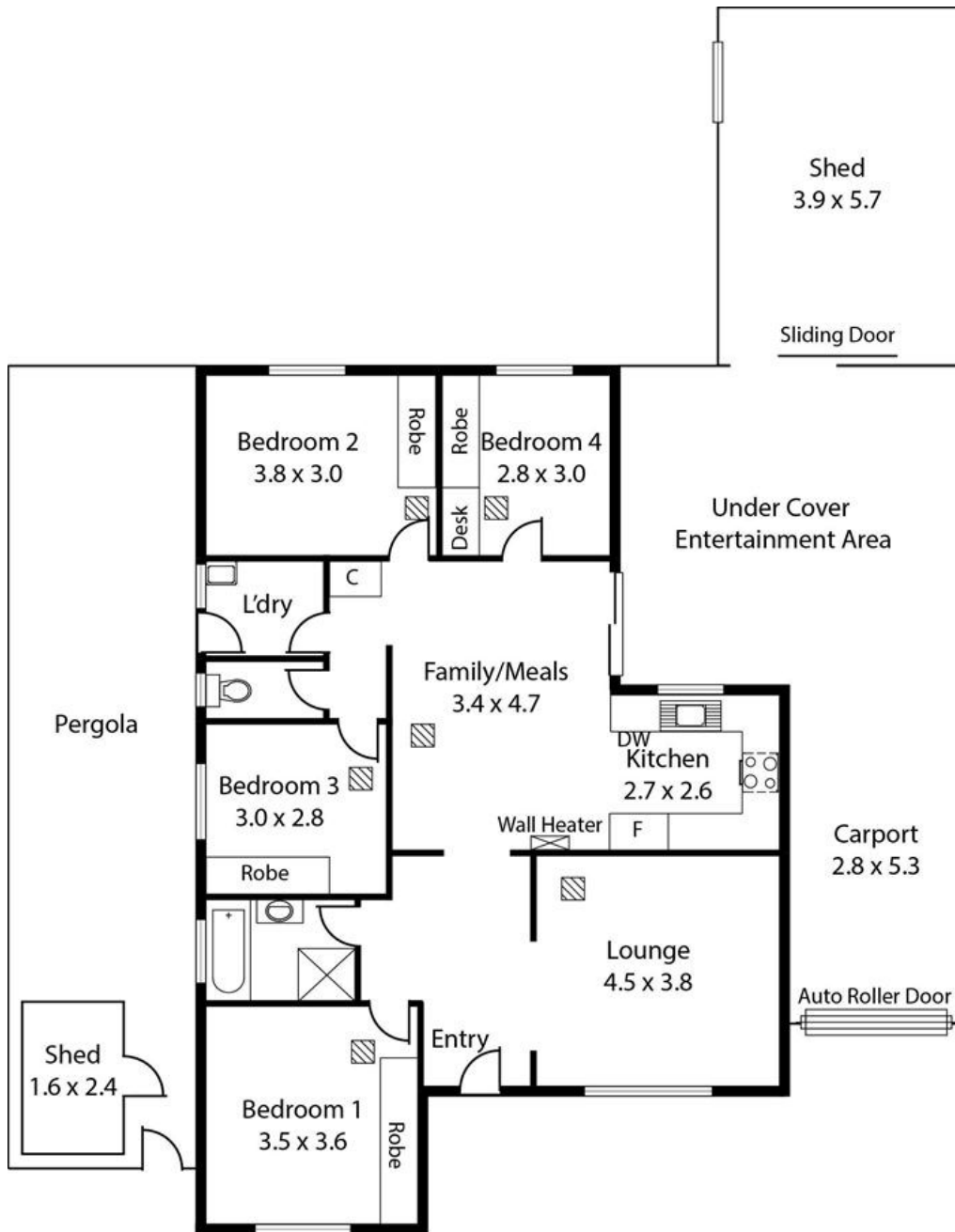

Living:	104.35 sqm
Ent. Area:	28.05 sqm
Pergola:	38.40 sqm
Sheds:	26.07 sqm
Carport:	14.84 sqm
Total:	211.71 sqm

This Drawing is for illustration purposes only. All measurements are approximate and details intended to be relied upon should be independently verified.