



10 Julie Crescent, **Goonellabah**

4 3 3

MASTERBUILT FAMILY HOME + POOL

A masterbuilt brick and terracotta tiled roof residence situated in a private & peaceful end of quiet cul de sac.

The home is on 2 levels with level front yard, tiled front patio and foyer, carpeted lounge and timber flooring in the air-conditioned dining/kitchen areas which has quality fittings and huge pantry. 4 double bedrooms, main with large ensuite and walk-in robe, all carpeted and have ceiling fans plus built-in robes. Beautiful main bathroom, tiled to the ceiling plus separate toilet. Throughout are high 3m ceilings with attractive cornices.

Internal access to tiled laundry with built-ins, separate carpeted utility room and a huge rumpus room which flows to the outdoor BBQ/living area. Triple lockup garage with 2 remotes plus workshop/storage. Off the BBQ area is a lovely pebble deck, inground pool plus large pool/storage room. Lovely northerly aspect capturing views and cooling breezes. A great family home.

891 sqm

\$549,000

ID# 11973102893

Open for Inspection

Sat 17 Jun, 12:00pm - 12:30pm



Gerald Pollard

02 6623 3200

0408 666 899

The above information has been furnished to us by the vendor of each property. We have not verified whether or not that information is accurate and have no belief one way or another in its accuracy. We do not accept any responsibility to any person for its accuracy and do no more than pass it on. all interested parties should make and rely upon their own enquires in order to determine whether or not this information is in fact accurate.

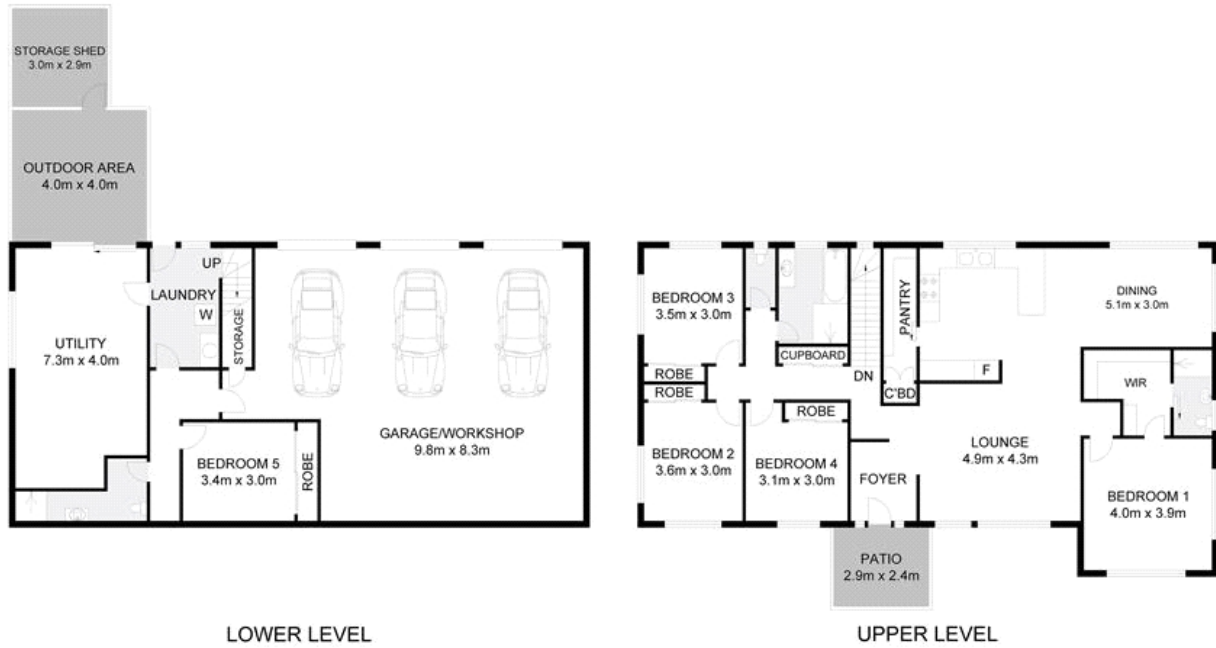

0 1 2 3 4 5

Scale in meters, indicative only. Dimensions are approximate. All information contained herein gathered from sources we believe to be reliable. However we cannot guarantee its accuracy and interested persons should rely on their own enquiries.

INT : 213.50m²
EXT : 32.40m²
GARAGE : 78.30m²



10 Julie Cres, Goonellabah