



27 Elsie Street, Port Augusta

OPEN TO IDEAS - Landlord Negotiable

Known and operated as a suburban delicatessen for a number of years - the Elsie Street Deli. Solid besa brick building with glazed frontage. Comprises a large retail area, office, kitchen, cool room and side storage. Set on a large 1200m2 allotment.

 1,207 sqm

Negotiable

ID# 41735130030



Michael Rowbottom
0412 399 366

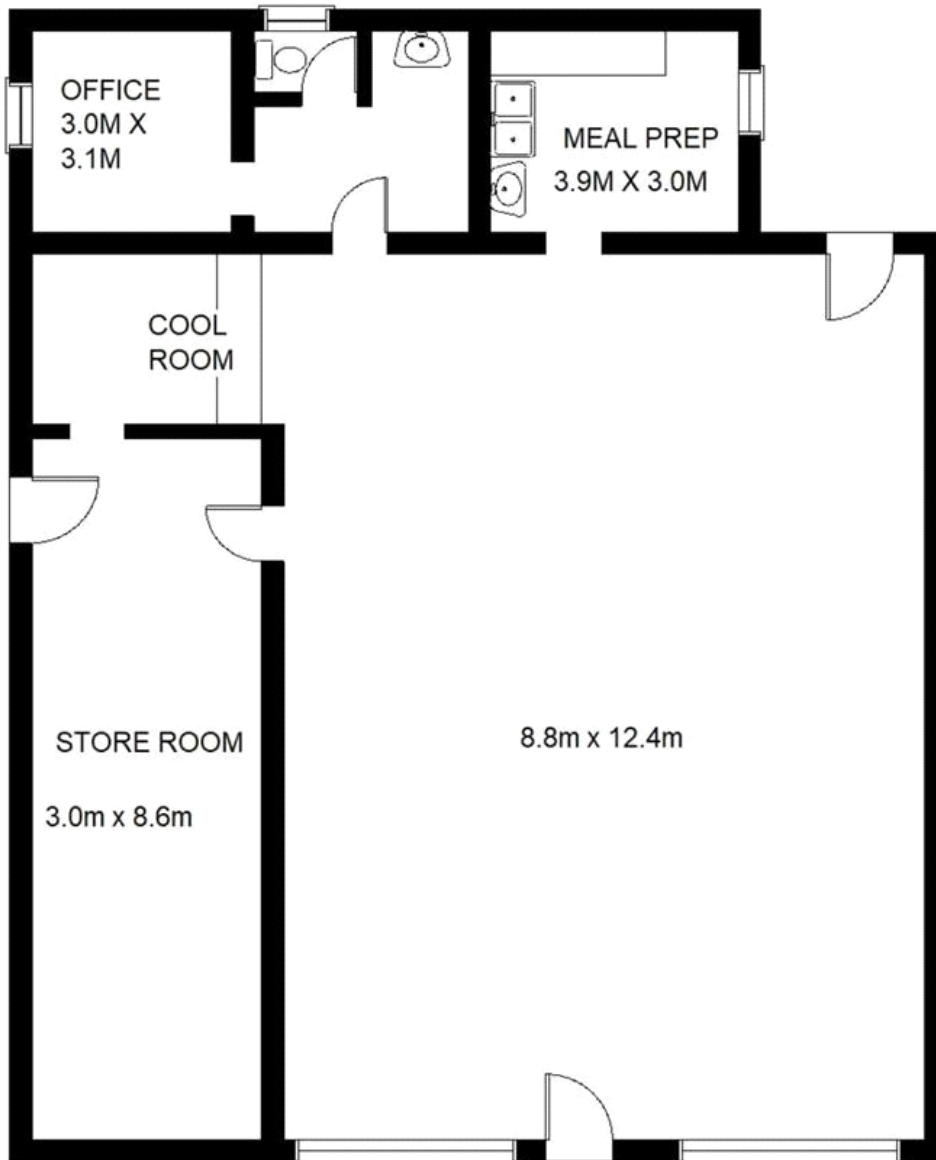

LIVING AREA